

Proposed changes to Millennium Walk at St Saviour's reservoir by Guernsey Water

Notice Board and Signs across site
1:20

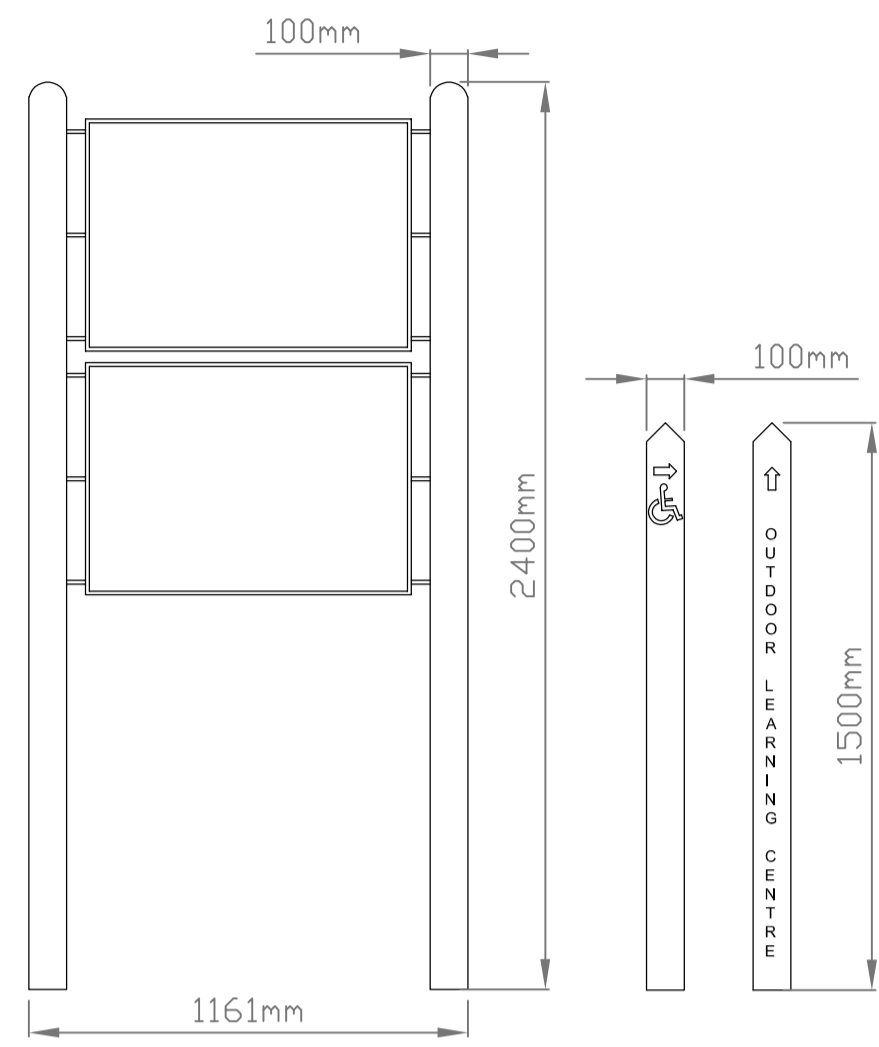

Artists impression of the Outdoor Learning Centre

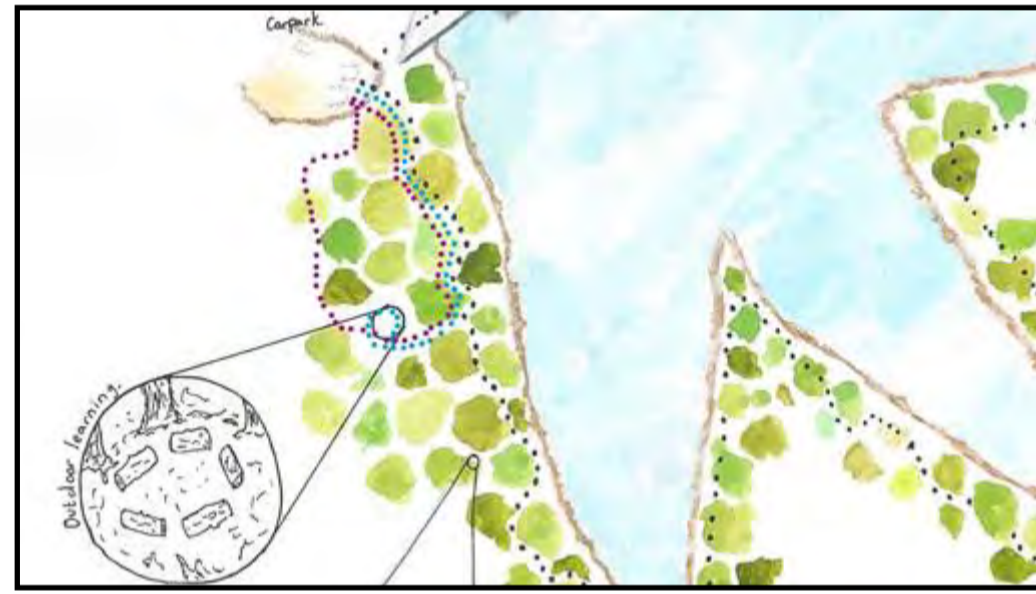

Outdoor Learning Centre 1:200

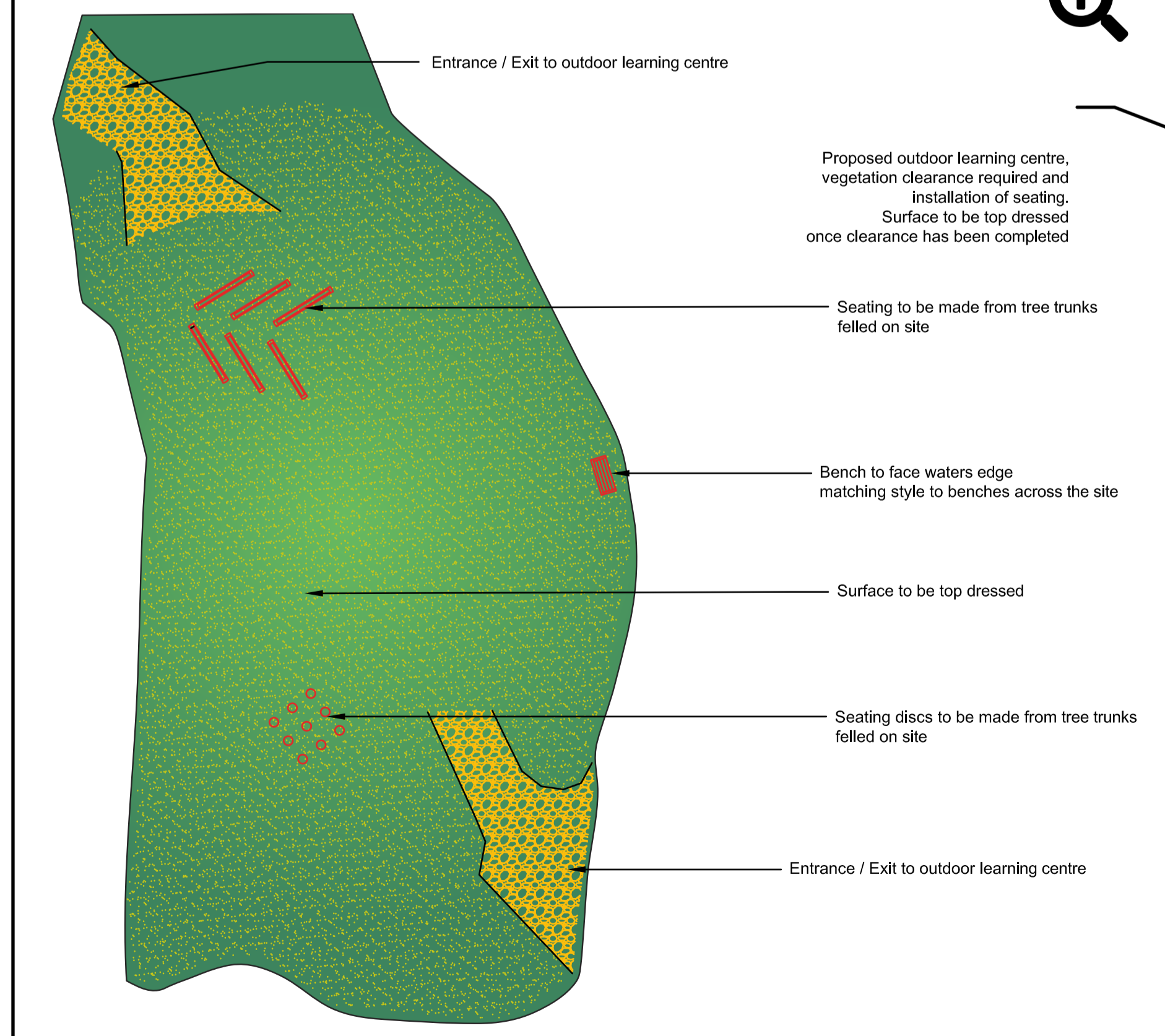

Cross-Section of granite stone areas
1:10

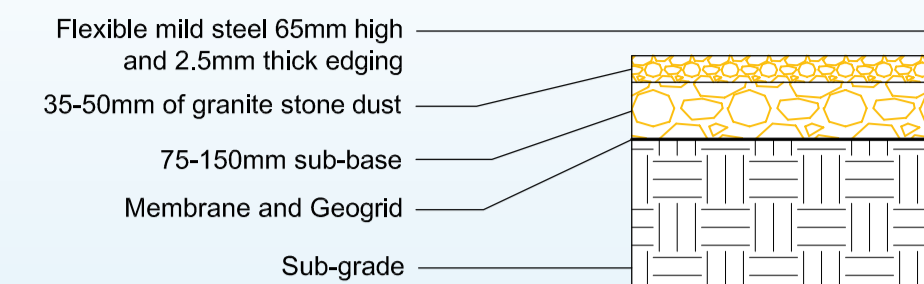

- Notes:**
1. If in DOUBT seek guidance of the Engineer
 2. All dimensions are in millimeters unless notated otherwise
 3. All levels are in metres relative to Guernsey datum
 4. Do NOT scale off this drawing

Site Location

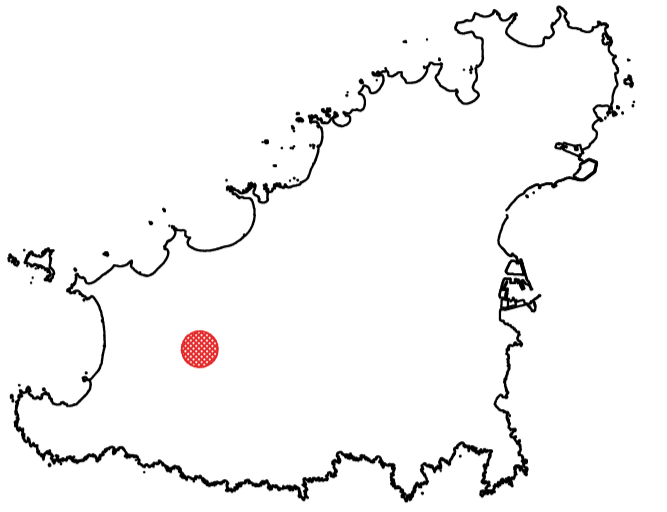

The highlighted section of pathway requires splitting from a single 20m incline into two 7.5m inclines with a single 5m landing.

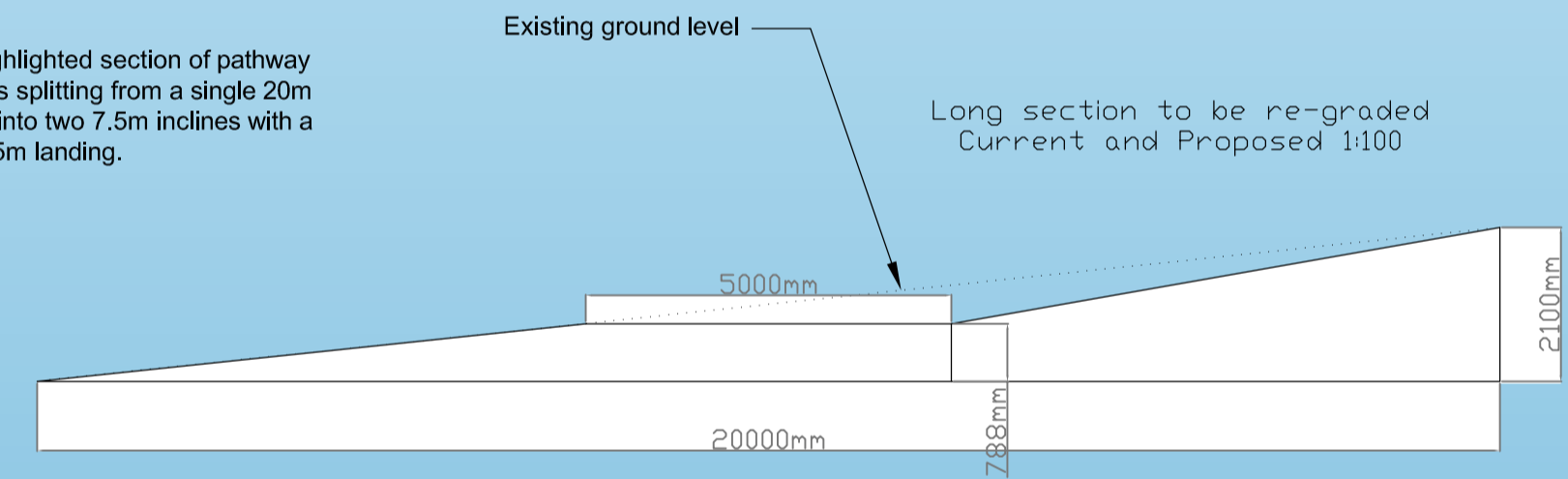

Scale 1:500

Legend	
Outdoor Learning Centre	
Granite stone dust Landing areas, Passing Points and Pathway redirection	
Current pathway material To be top dressed	

Rev	Description	By	Date	CHK'd	Auth
-	-	-	-	-	-

GuernseyWater

PO Box 30
Brickfield House
St Andrews
Guernsey
GY1 3AS

Tel: 01481 239500
Fax: 01481 234649
www.water.gg

Project Manager
-

Project
Millennium Walk Alterations

Title
Block Plan - Alterations and Outdoor Learning Centre Design

Sheet Size	Original Scale	Designed/Drawn	Checked	Authorised
A1	-	DCO	-	-
Project Number	Drawing Number	Date	Date	Date
00_2020_0000	001	-	-	-